



AUTOMATISCHE
SCHLAUCHAUFRÖLLER

Edelstahlausführung

Im Vertrieb der

Schäffner GmbH
www.schaeffner-tools.de



AUTOMATISCHE SCHLAUCHAUFROLLER

Die Verwendung von Schlauchaufrollern trägt dazu bei, den Arbeitsplatz sauber und ordentlich zu bewahren und bietet bedeutende Vorteile:

- **SICHERHEIT** weil die Gefahr von liegenden Schläuchen buchstäblich aus dem Weg geräumt wird
- **LEBENSDAUER** des Schlauchs wird erhöht, da in aufgerollter Lage der Schlauch nicht beschädigt wird
- **ZEITERERSPARNIS** weil das Herausziehen und Wiederaufrollen ohne Entwirren des Schlauches erfolgt
- **BEQUEMLICHKEIT** weil der Schlauch in der benötigten Länge herausgezogen und automatisch wieder aufgerollt wird
- **PRODUKTIVITÄT** wird gesteigert, weil die Werkzeuge immer in Reichweite sind
- **HYGIENE** im Lebensmittelbereich, weil der immer bis aufs Maximum eingerollte Schlauch kein Dreck sammelt

Die Marke **FAICOM Italy** umfasst eine umfangreiche Bandbreite von automatischen Schlauchaufrollern, um die unterschiedlichen Bedürfnisse des Benutzers zu befriedigen. Sie sind für die Abgabe von verschiedenen Flüssigkeiten wie Druckluft, Wasser, Öl, Fette, Diesel, Harnstoff (AdBlue), Schweißgase einsetzbar und finden große Verwendung in unterschiedlichen Branchen, wie KFZ-Werkstätten, KFZ-Waschanlagen, in der Industrie, in der Landwirtschaft, in der Lebensmittelindustrie und in der Fleischverarbeitung. Sie sind in beschichtetem oder Edelstahl erhältlich und können auf Anfrage zum Einsatz an Arbeitsplätzen mit explosionsgefahr, mit Erfüllung der ATEX Richtlinie 2014/34/UE mit der Kennzeichnung **CE**  **II 2G / II 2D** geliefert werden. Die Bandbreite umfasst auch Elektrokabel- sowie Aufroller mit Vorhängen. Gleichzeitig werden Einfetter und Flüssigkeitsverteiler hergestellt: hydraulische Fett-, Öl-, Diesel-, AdBlue- und Enteisungspumpen, sowie Saugmaschinen für Restöl (s. Spezialkatalog).

Schlauchaufroller Edelstahlausführung AISI 304/316

SMALL SIZE



MPX short length
pag. 50 | \varnothing 200
3 m (3/8") - 5 m (5/16")



MGPX light duty
pag. 52 | \varnothing 290
12 m (3/8") - 15 m (5/16")



MEDIUM SIZE



MCX closed range
pag. 54 | \varnothing 410
up to: 10 m (1/2"-3/8") - 15 m (5/16")



AX-ALX heavy duty
pag. 56-58 | \varnothing 410
up to: 15 m (5/8") - 20 m (1/2")



VX-VLX versatile
pag. 60-62 | \varnothing 410
up to: 15 m (5/8") - 20 m (1/2")



VGX-VGLX versatile large
pag. 64-66 | \varnothing 445
up to: 10 m (1") - 15 m (3/4") - 25 m (1/2")



LARGE SIZE



VGMX versatile maxi
pag. 68 | \varnothing 445
up to: 15 m (1") - 20 m (3/4")



BGX-BGDX heavy duty
pag. 70 | \varnothing 550
up to: 15 m (1") - 20 m (3/4") - 30 m (1/2")



BGLX-BGLDX high capacity
pag. 72 | \varnothing 550
up to: 30 m (1") - 40 m (3/4") - 50 m (1/2")



Schlauchaufroller - Edelstahlausführung

Die Marke FAICOM Italy hat eine Bandbreite von Edelstahl Schlauchaufrollern, wie AISI 304 und **AISI 316**, welche hauptsächlich Waschvorgängen mit Wasser und Reinigungsmitteln dienen, sowie Trinkwasser, Druckluft als auch Diesel. Sie dienen in versch. Branchen, wie der Lebensmittelindustrie, auf Schlachthöfen, in der Fischverarbeitung, in Käsereien, Großküchen, chem. und Pharma-Industrie, sowie in Schwimmbädern.

Die Modelle in der Variante „TX“ in AISI 316 empfehlen sich, aufgrund des Korrosionsschutzes, besonders in der Schiffsbranche oder Lebensmittelindustrie, in Chemie- und Pharma-Industrie. Der Schlauch wird durch eine qualitativ hochwertige Feder aufgerollt und in der gewünschten Position angehalten.

Einige Modelle sind mit dem System „SAFE REWIND“ ausgestattet und ermöglichen ein verlangsamt und sicheres Aufrollen.

Die Drehgelenke garantieren maxim. Durchsätze und bestehen aus passenden Materialien entsprechend den untersch. Anforderungen.

Die Serie enthält versch. Modelle mit offenen und geschl. Versionen.

Im Katalog befinden sich drei große Schlauchaufrollgruppen: klein/mittel/groß je nach Bedarf.



VERSION **TX** HIGH CORROSION RESISTANCE
AISI316



Im Vertrieb der
Schäffner GmbH
www.schaeffner-tools.de

MPX^{short length}

STAINLESS STEEL AISI 304

ø 200 mm
drum/tamburo

connection hose included
tubo di collegamento incluso

special polyurethane hose
for hot water
*tubo in poliuretano speciale
per acqua calda*

optional
DC38S



DC38PRS



P12ARNF



only for / per
MPX201003

**HOT
WATER
70°C**



Schlauchaufroller für Waschvorgänge mit Wasser und Reinigungsmittel, sowie zum Transport von Trinkwasser und Druckluft.

Verteilungsschlauch ist aus verstärktem Polyurethan, cord armiert.

Verbindungsschlauch mit 1 m Länge.

Mit Schwenkkonsole zur Orientierung in Richtung des Benutzers.

Im Vertrieb der

Schäffner
GmbH
www.schaeffner-tools.de

Dimensions (mm) / Dimensioni (mm)

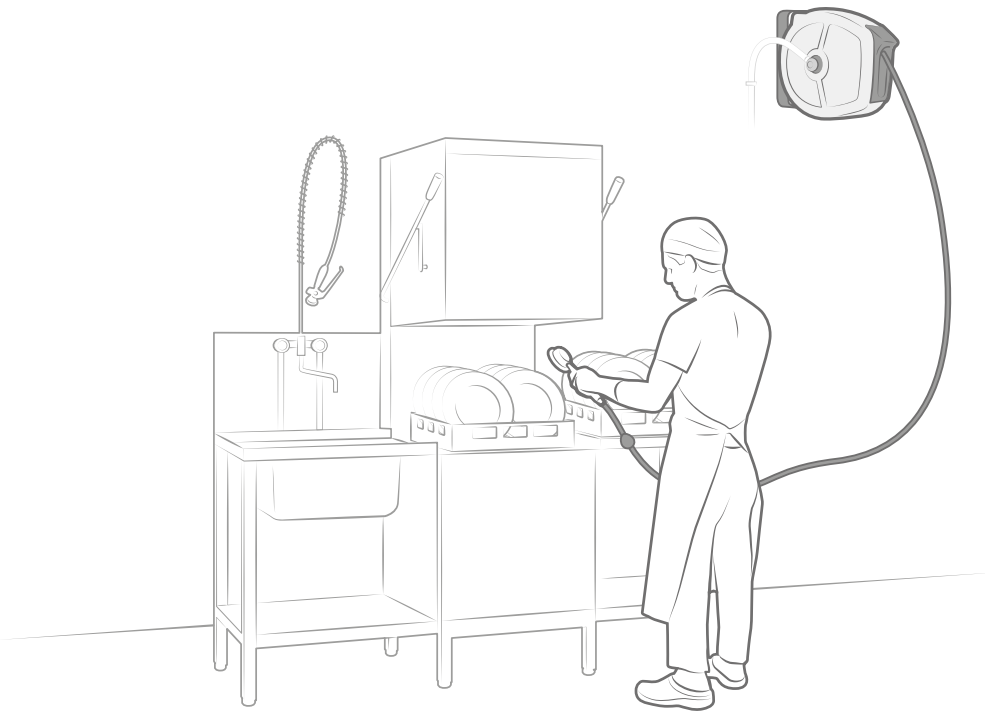
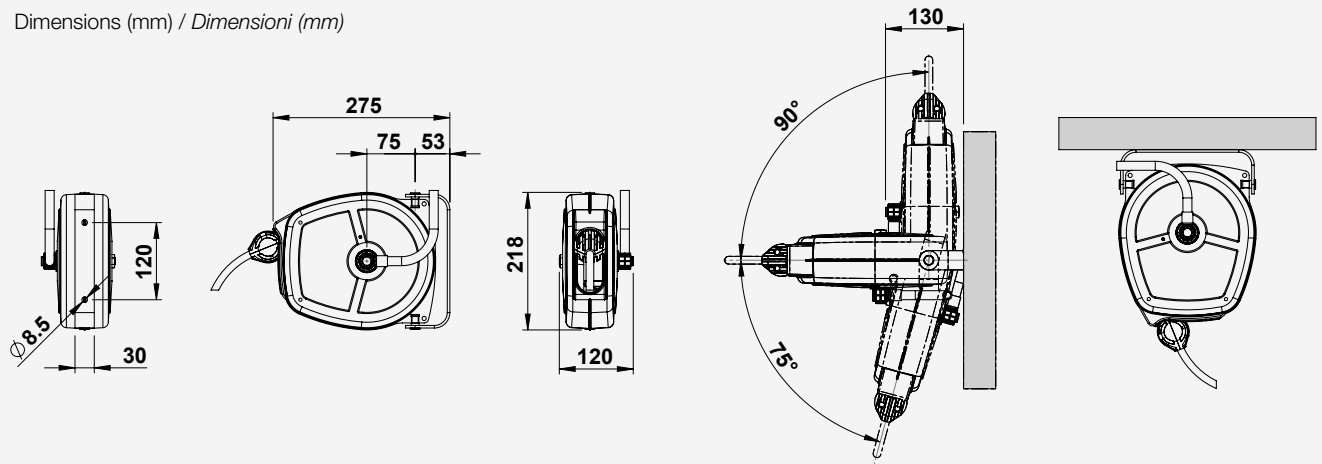

Hose reels model MPX with hose / Avvolgitubo modello MPX completi di tubo

Fluid Fluido	Pressure - Hose Pressione - Tubo	Code Codice	Inlet (mm) Entrata (mm)	Outlet (Bsp) Uscita (Gas)	Hose diam. Tubo diam.	Hose length Lungh. Tubo	Weight (kg) Peso (kg)
Air/Aria Water-detergents Acqua-detergente 70°C	20 Bar/280 PSI (25°C) 10 Bar/140 PSI (70°C) Polyurethane/Poliuretano	MPX200805	Ø 8	1/4" M	8 x 12	5 m/16 ft	3
		MPX201003	Ø 10	3/8" M	10 x 14	3 m/10 ft	3

MGPX^{light duty}

STAINLESS STEEL AISI 304

ø 290 mm
drum/tamburo

connection hose
included
*tubo di collegamento
incluso*

special polyurethane
hose for hot water
*tubo in poliuretano
speciale per acqua
calda*

optional
DC38S



DC38PRS



P12ARNF



P12A80



only for / per
MGPX201012
MGPSX201012



Schlauchaufroller für Waschvorgänge mit Wasser und Reinigungsmittel, sowie zum Transport von Trinkwasser und Druckluft.

Der Verteilungsschlauch ist aus verstärktem Polyurethan, cord armiert.

Verbindungsschlauch mit 1 m Länge.

Mit Schwenkkonsole zur Orientierung in Richtung des Benutzers.

Bei Version MGPSX mit "SAFE REWIND" für verlangsamtes Aufrollen.

Dimensions (mm) / Dimensioni (mm)

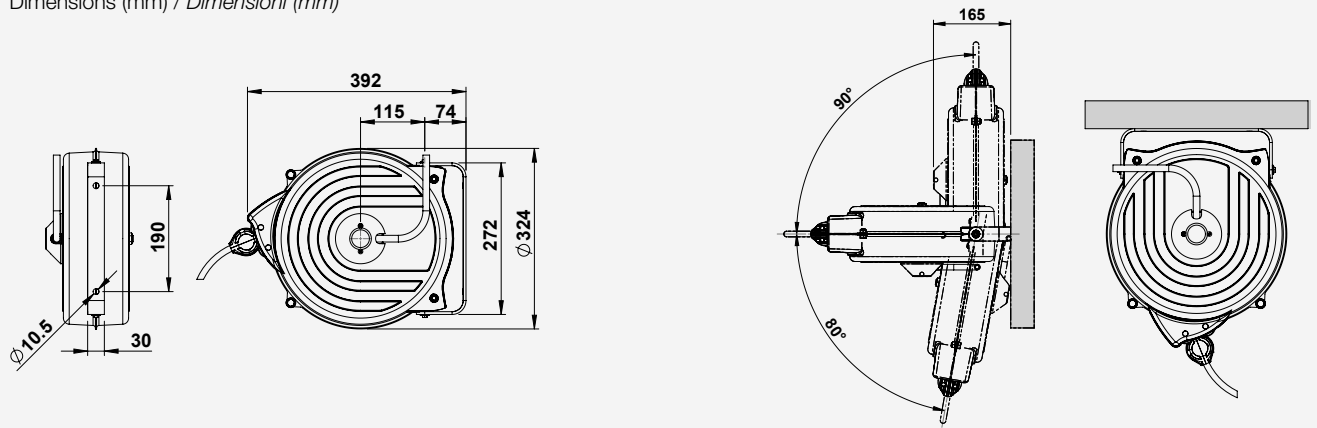

Three possible positions of the connection hose
Tre posizioni possibili del tubo di collegamento

Le tre posizioni possibili del tubo di collegamento



New brake system "SAFE REWIND".
It allows to rewind the hose at controlled speed and in total safety.
*Nuovo sistema frenante incorporato "SAFE REWIND".
Consente di riavvolgere il tubo in modo rallentato e in piena sicurezza.*



Hose reels model MGP(S)X with hose / Avvolgitubo modello MGP(S)X completi di tubo

Fluid Fluido	Pressure - Hose Pressione - Tubo	Code Codice	Inlet (mm) Entrata (mm)	Outlet (Bsp) Uscita (Gas)	Hose diam. Tubo diam.	Hose length Lungh. Tubo	Weight (kg) Peso (kg)	Safe Rewind
Air/Aria Water-detergents Acqua-detergente 70°C	20 Bar/280 PSI (25°C) 10 Bar/140 PSI (70°C) Polyurethane/Poliuretano	MGPX200815	Ø 8	1/4" M	8 x 12	15 m/50 ft	6,7	
		MGPX201012	Ø 10	3/8" M	10 x 14	12 m/40 ft	6,7	
		MGPSX200815	Ø 8	1/4" M	8 x 12	15 m/50 ft	7,5	•
		MGPSX201012	Ø 10	3/8" M	10 x 14	12 m/40 ft	7,5	•

MCX_{closed range}

STAINLESS STEEL AISI 304

ø 410 mm
drum/tamburo

optional
INLET HOSE



MCXSG10



P12ARNF



P12A80/P12A95



II 2G/D
optional



Standard: 4-rollers hose-guide
Di serie: guida tubo a 4 rulli



Schlauchaufroller für Waschvorgänge mit Wasser und Reinigungsmittel für versch. Betriebstemperaturen und -drücke, sowie bei lebensmittelechtem Schlauch auch zum Transport von Trinkwasser.

Verankerungshaken für 3 verschied. Positionen (s.Abb. A-B-C).

Serienmäßig: Schlauchführung mit 4 Rollen.

Optional: Verbindungsschlauch, Schwenkkonsole.

Im Vertrieb der

Schäffner
ambt
www.schaeffner-tools.de

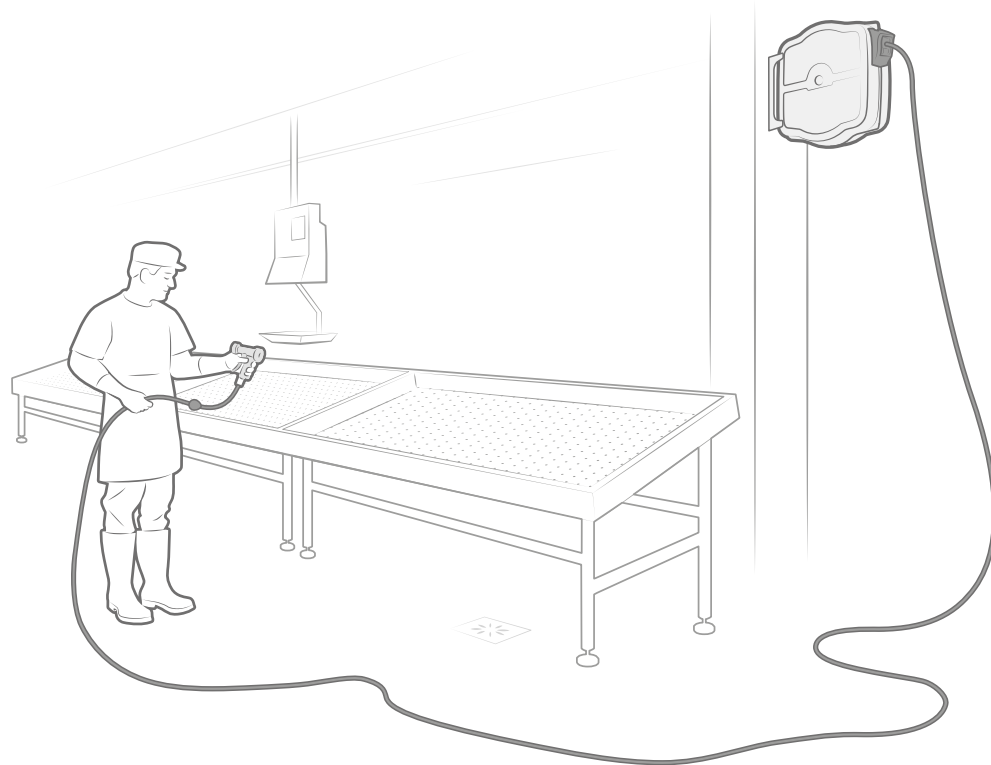
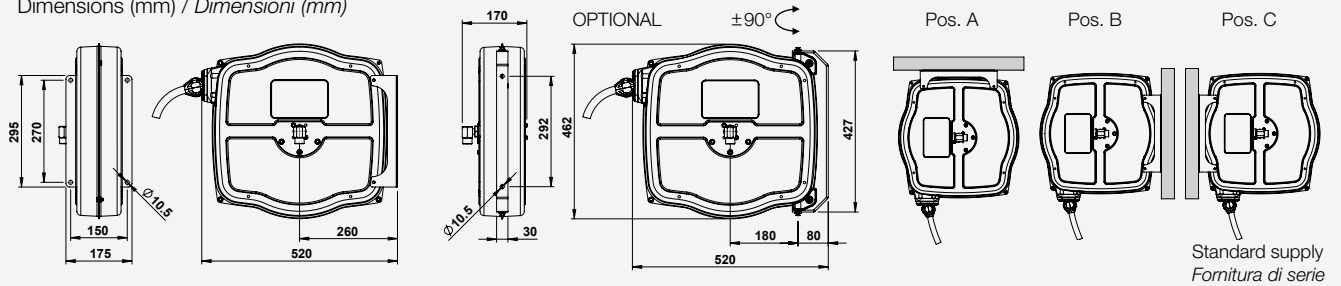

Dimensions (mm) / Dimensioni (mm)



Hose reels model MCX without hose / Avvolgitubo modello MCX senza tubo

Fluid Fluido	Max. pressure Pressione max.	Code Codice	Inlet (Bsp) Entrata (Gas)	Outlet (Bsp) Uscita (Gas)	Capacity Capacità	Weight (kg) Peso (kg)	ATEX (optional)
Water/Acqua 100°C	60 Bar/840 PSI	MCX601215ST	1/2" M	1/2" M	15 m/50 ft	15	•
Water/Acqua 150°C	400 Bar/5600 PSI	MCX4H3815ST	3/8" F	3/8" M	15 m/50 ft	15	•

Hose reels model MCX with hose / Avvolgitubo modello MCX completi di tubo

Fluid Fluido	Pressure - Hose Pressione - Tubo	Code Codice	Inlet (Bsp) Entrata (Gas)	Outlet (Bsp) Uscita (Gas)	Hose diam. Tubo diam.	Hose length Lungh. Tubo	Weight (kg) Peso (kg)	Inlet hose Tubo entrata	ATEX (optional)
Water/Acqua 70°C	10 Bar/140 PSI (70°C)	MCX101310K	1/2" M	1/2" M	13 x 20	10 m/32 ft	18	TC13005K	
	20 Bar/280 PSI (25°C) Blue Thermoplastic 	MCX101315K	1/2" M	1/2" M	13 x 20	15 m/50 ft	19	TC13005K	
Water/Acqua 90°C	10 Bar/140 PSI Blue Rubber/Gomma 	MCX101310KR	1/2" M	1/2" M	13 x 21	10 m/32 ft	18	TC1301KR	
Water/Acqua 150°C	400 Bar/5600 PSI 2SC Hydro blue	MCX4H3810	3/8" F	3/8" M	3/8"	10 m/32 ft	20	TC38005H	•
		MCX4H5115	3/8" F	3/8" M	5/16"	15 m/50 ft	20	TC38005H	•

AX heavy duty

STAINLESS STEEL AISI 304

ø 410 mm
drum/tamburo

4R Optional 4-rollers
hose guide
*Guida tubo a 4 rulli
opzionale*

optional
INLET HOSE

AXSG15R

P12ARNF

P12A80/P12A95

II 2G/D
optional



4R - Optional 4-rollers hose guide.
Ordering the version indicating the
hose reel code followed by "4R"
4R - Guida tubo a 4 rulli opzionale.
*ordinare la versione indicando
il codice dell'avvolgitubo
seguito da "4R"*



Schlauchaufroller für Waschvorgänge mit Wasser und Reinigungsmittel für versch. Betriebstemperaturen und -drücke, sowie bei lebensmittelechtem Schlauch auch zum Transport von Trinkwasser.

Schlauchführungshalterung für 2 verschied. Positionen (s.Abb. A-B).

Optional: Schlauchführung mit 4 Rollen, Verbindungsschlauch, Schwenkkonsole.

Dimensions (mm) / Dimensioni (mm)

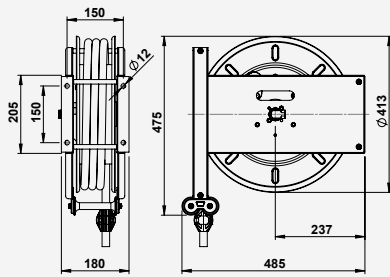

OPTIONAL ±60°

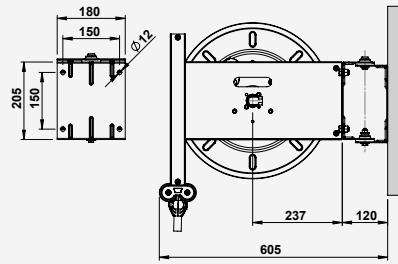

Pos. A

Pos. B

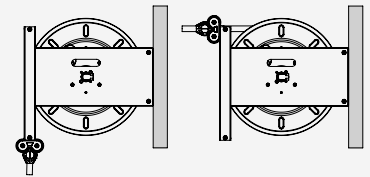



Standard supply
Fornitura di serie

Hose reels model AX without hose / Avvolgitubo modello AX senza tubo

Fluid Fluido	Max. pressure Pressione max.	Code Codice	Inlet (Bsp) Entrata (Gas)	Outlet (Bsp) Uscita (Gas)	Capacity Capacità	Weight (kg) Peso (kg)	ATEX (optional)
Water/Acqua 100°C	60 Bar/840 PSI	AX601215ST	1/2" M	1/2" M	(1/2") 15 m/50 ft (5/8") 10 m/32 ft	15,5	•
Water/Acqua 150°C	400 Bar/5600 PSI	AX4H3815ST	3/8" F	3/8" M	15 m/50 ft	15,5	•

Hose reels model AX with hose / Avvolgitubo modello AX completi di tubo

Fluid Fluido	Pressure - Hose Pressione - Tubo	Code Codice	Inlet (Bsp) Entrata (Gas)	Outlet (Bsp) Uscita (Gas)	Hose diam. Tubo diam.	Hose length Lungh. Tubo	Weight (kg) Peso (kg)	Inlet hose Tubo entrata	ATEX (optional)
Water Acqua 70°C	10 Bar/140 PSI (70°C) 20 Bar/280 PSI (25°C) Blue Thermoplastic 	AX101310K	1/2" M	1/2" M	13 x 20	10 m/32 ft	18	TC13005K	
		AX101315K	1/2" M	1/2" M	13 x 20	15 m/50 ft	20	TC13005K	
		AX101610K	1/2" M	1/2" M	16 x 23	10 m/32 ft	19	TC16005K	
Water Acqua 90°C	10 Bar/140 PSI Blue Rubber/Gomma 	AX101310KR	1/2" M	1/2" M	13 x 21	10 m/32 ft	18	TC1301KR	
		AX101315KR	1/2" M	1/2" M	13 x 21	15 m/50 ft	20	TC1301KR	
Water Acqua 150°C	250 Bar/3500 PSI 1SC Hydro blue	AX2H3815	3/8" F	3/8" M	3/8" M	15 m/50 ft	21	TC38005H	
		AX4H3810	3/8" F	3/8" M	3/8"	10 m/32 ft	20	TC38005H	
		AX4H3815	3/8" F	3/8" M	3/8"	15 m/50 ft	22	TC38005H	•
		AX4H5115	3/8" F	3/8" M	5/16"	15 m/50 ft	21	TC38005H	•
		*AX4H3815X	3/8" F	3/8" F	3/8"	15 m/50 ft	22	not available	

*Hose with stainless steel fittings / Tubo con raccordi in acciaio inox

ALX heavy duty

STAINLESS STEEL AISI 304

ø 410 mm
drum/tamburo

4R Optional 4-rollers
hose guide
*Guida tubo a 4 rulli
opzionale*

optional
INLET HOSE

ALXSG20R

P12ARNF

P12A80/P12A95

II 2G/D
optional



4R - Optional 4-rollers hose guide.
Ordering the version indicating the
hose reel code followed by "4R"
4R - Guida tubo a 4 rulli opzionale.
*ordinare la versione indicando
il codice dell'avvolgitubo
seguito da "4R"*



Schlauchaufroller für Waschvorgänge mit Wasser und Reinigungsmittel für versch. Betriebstemperaturen und -drücke, sowie bei lebensmittelechtem Schlauch auch zum Transport von Trinkwasser.
Schlauchführungshalterung für 2 verschied. Positionen (s.Abb. A-B).
Optional: Schlauchführung mit 4 Rollen, Verbindungsschlauch, Schwenkkonsole.

Dimensions (mm) / Dimensioni (mm)

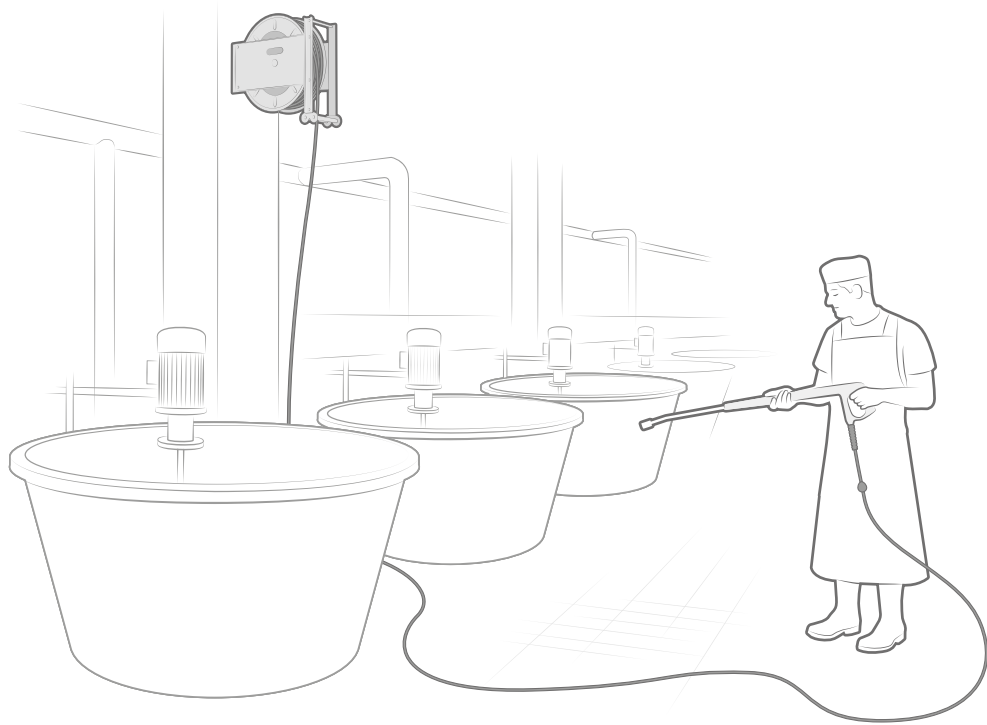
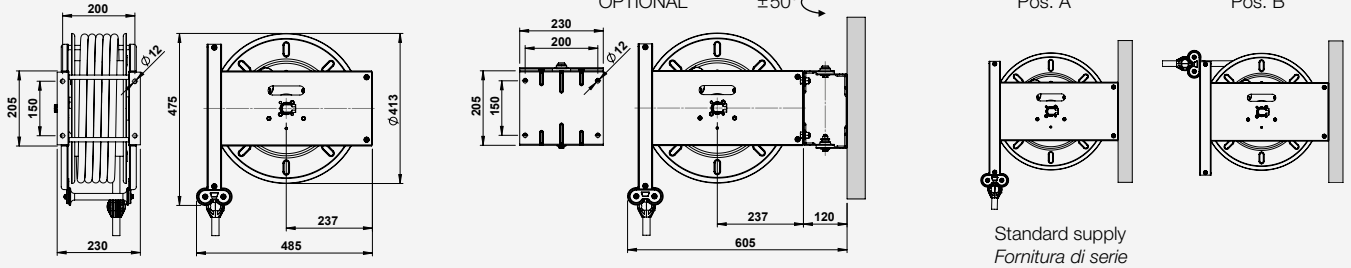

Hose reels model ALX without hose / Avvolgitubo modello ALX senza tubo

Fluid Fluido	Max. pressure Pressione max.	Code Codice	Inlet (Bsp) Entrata (Gas)	Outlet (Bsp) Uscita (Gas)	Capacity Capacità	Weight (kg) Peso (kg)	ATEX (optional)
Water/Acqua 100°C	60 Bar/840 PSI	ALX601220ST	1/2" M	1/2" M	(1/2") 20 m/65 ft (5/8") 15 m/50 ft	20	•
Water/Acqua 150°C	400 Bar/5600 PSI	ALX4H3820ST	3/8" F	3/8" M	20 m/65 ft	20	•

Hose reels model ALX with hose / Avvolgitubo modello ALX completi di tubo

Fluid Fluido	Pressure - Hose Pressione - Tubo	Code Codice	Inlet (Bsp) Entrata (Gas)	Outlet (Bsp) Uscita (Gas)	Hose diam. Tubo diam.	Hose length Lungh. Tubo	Weight (kg) Peso (kg)	Inlet hose Tubo entrata	ATEX (optional)
Water Acqua 70°C	10 Bar/140 PSI (70°C) 20 Bar/280 PSI (25°C) Blue Thermoplastic 	ALX101320K	1/2" M	1/2" M	13 x 20	20 m/65 ft	25	TC13005K	
		ALX101615K	1/2" M	1/2" M	16 x 23	15 m/50 ft	25	TC16005K	
Water Acqua 90°C	10 Bar/140 PSI Blue Rubber/Gomma	ALX101320KR	1/2" M	1/2" M	13 x 21	20 m/65 ft	25	TC1301KR	
		ALX101615KR	1/2" M	1/2" M	16 x 25	15 m/50 ft	25	TC1601KR	
Water Acqua 150°C	250 Bar/3500 PSI 1SC Hydro blue	ALX2H3820	3/8" F	3/8" M	3/8"	20 m/65 ft	27	TC38005H	
		ALX4H3820	3/8" F	3/8" M	3/8"	20 m/65 ft	28	TC38005H	•
		ALX4H5120	3/8" F	3/8" M	5/16"	20 m/65 ft	27	TC38005H	
		*ALX4H3820X	3/8" F	3/8" F	3/8"	20 m/65 ft	28	not available	

* Hose with stainless steel fittings / Tubo con raccordi in acciaio inox

STAINLESS STEEL AISI 304

ø 410 mm
drum/tamburo

4R Optional 4-rollers
hose guide
*Guida tubo a 4 rulli
opzionale*

optional
INLET HOSE

AXSG15R

VCAR

P12ARNF

P12A80/P12A95

 II 2G/D
optional



4R - Optional 4-rollers hose guide.
Ordering the version indicating the
hose reel code followed by "4R"
4R - Guida tubo a 4 rulli opzionale.
*ordinare la versione indicando il codice
dell'avvolgitubo seguito da "4R"*



Schlauchaufroller für Waschvorgänge mit Wasser und Reinigungsmittel für versch. Betriebstemperaturen und -drücke, sowie bei lebensmittelechtem Schlauch auch zum Transport von Trinkwasser.

Schwenkbare Arme für 3 versch. Positionen (s.Abb. A-B-C).

Optional: Verbindungsschlauch, seitliche Schutzverkleidungen, Schwenkkonsole, Schlauchführung mit 4 Rollen

Dimensions (mm) / Dimensioni (mm)

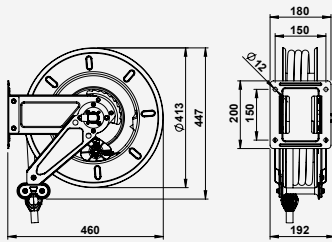

OPTIONAL ±60°

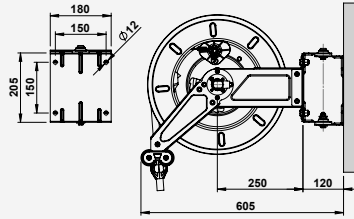

Pos. A

Pos. B

Pos. C

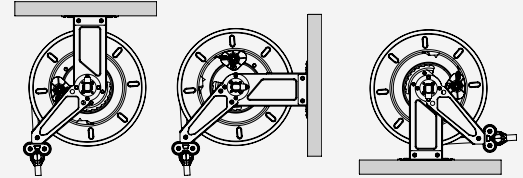

Standard supply
Fornitura di serie





Optional version with lateral protective covers
Versione optional con carter laterali di protezione

Hose reels model VX without hose / Avvolgitubo modello VX senza tubo

Fluid Fluido	Max. pressure Pressione max.	Code Codice	Inlet (Bsp) Entrata (Gas)	Outlet (Bsp) Uscita (Gas)	Capacity Capacità	Weight (kg) Peso (kg)	ATEX (optional)
Water/Acqua 100°C	60 Bar/840 PSI	VX601215ST	1/2" M	1/2" M	(1/2") 15 m/50 ft (5/8") 10 m/32 ft	14,5	•
Water/Acqua 150°C	400 Bar/5600 PSI	VX4H3815ST	3/8" F	3/8" M	15 m/50 ft	14,5	•

Hose reels model VX with hose / Avvolgitubo modello VX completi di tubo

Fluid Fluido	Pressure - Hose Pressione - Tubo	Code Codice	Inlet (Bsp) Entrata (Gas)	Outlet (Bsp) Uscita (Gas)	Hose diam. Tubo diam.	Hose length Lungh. Tubo	Weight (kg) Peso (kg)	Inlet hose Tubo entrata	ATEX (optional)
Water Acqua 70°C	10 Bar/140 PSI (70°C) 20 Bar/280 PSI (25°C) Blue Thermoplastic 	VX101310K	1/2" M	1/2" M	13 x 20	10 m/32 ft	17	TC13005K	
		VX101315K	1/2" M	1/2" M	13 x 20	15 m/50 ft	19	TC13005K	
		VX101610K	1/2" M	1/2" M	16 x 23	10 m/32 ft	18	TC16005K	
Water Acqua 90°C	10 Bar/140 PSI Blue Rubber/Gomma 	VX101310KR	1/2" M	1/2" M	13 x 21	10 m/32 ft	17	TC1301KR	
		VX101315KR	1/2" M	1/2" M	13 x 21	15 m/50 ft	19	TC1301KR	
Water Acqua 150°C	250 Bar/3500 PSI 1SC Hydro blue	VX2H3815	3/8" F	3/8" M	3/8" M	15 m/50 ft	21	TC38005H	
		VX4H3810	3/8" F	3/8" M	3/8"	10 m/32 ft	19	TC38005H	
	400 Bar/5600 PSI 2SC Hydro blue	VX4H3815	3/8" F	3/8" M	3/8"	15 m/50 ft	21	TC38005H	•
		VX4H5115	3/8" F	3/8" M	5/16"	15 m/50 ft	20	TC38005H	•
		*VX4H3815X	3/8" F	3/8" F	3/8"	15 m/50 ft	21	not available	

* Hose with stainless steel fittings / Tubo con raccordi in acciaio inox

ø 410 mm
drum/tamburo

4R Optional 4-rollers
hose guide
*Guida tubo a 4 rulli
opzionale*

optional
INLET HOSE



ALXSG20R



VCAR



P12ARNF



P12A80/P12A95



II 2G/D
optional



4R - Optional 4-rollers hose guide.
Ordering the version indicating the
hose reel code followed by "4R"
4R - Guida tubo a 4 rulli opzionale.
*ordinare la versione indicando il codice
dell'avvolgitubo seguito da "4R"*



Schlauchaufroller für Waschvorgänge mit Wasser und Reinigungsmittel für versch.

Betriebstemperaturen und -drücke, sowie bei lebensmittelechtem Schlauch auch zum Transport von Trinkwasser.

Schwenkbare Arme für 3 versch. Positionen (s.Abb. A-B-C).

Optional: Verbindungsschlauch, seitliche Schutzverkleidungen, Schwenkkonsole, Schlauchführung mit 4 Rollen.

Dimensions (mm) / Dimensioni (mm)

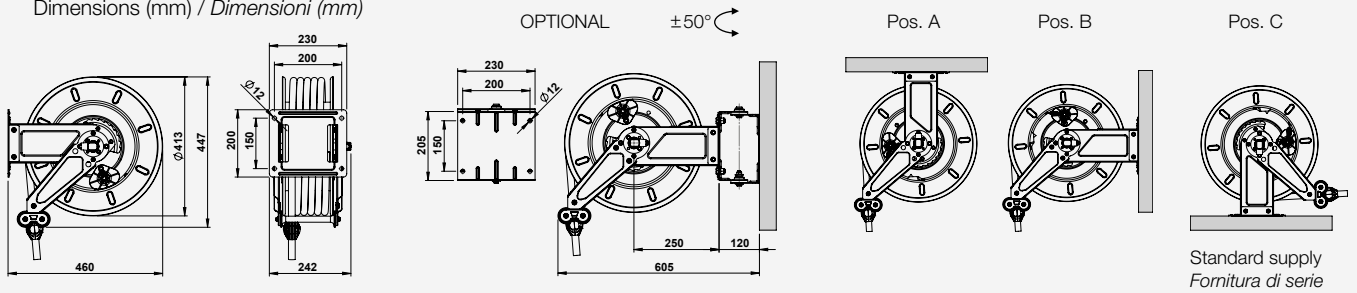

Optional version with lateral protective covers
Versione optional con carter laterali di protezione

Hose reels model VLX without hose / Avvolgitubo modello VLX senza tubo

Fluid Fluido	Max. pressure Pressione max.	Code Codice	Inlet (Bsp) Entrata (Gas)	Outlet (Bsp) Uscita (Gas)	Capacity Capacità	Weight (kg)	ATEX (optional)
Water/Acqua 100°C	60 Bar/840 PSI	VLX601220ST	1/2" M	1/2" M	(1/2") 20 m/65 ft (5/8") 15 m/50 ft	19	•
		VLX4H3820ST	3/8" F	3/8" M	20 m/65 ft	19	•
Water/Acqua 150°C	400 Bar/5600 PSI	VLX4H1220ST	1/2" M	1/2" M	(1/2"-1SC) 20 m/65 ft (1/2" -2SC) 15 m/50 ft	19	•

Hose reels model VLX with hose / Avvolgitubo modello VLX completi di tubo

Fluid Fluido	Pressure - Hose Pressione - Tubo	Code Codice	Inlet (Bsp) Entrata (Gas)	Outlet (Bsp) Uscita (Gas)	Hose diam. Tubo diam.	Hose length Lungh. Tubo	Weight (kg) Peso (kg)	Inlet hose Tubo entrata	ATEX (optional)
Water Acqua 70°C	10 Bar/140 PSI (70°C) 20 Bar/280 PSI (25°C) Blue Thermoplastic	VLX101320K	1/2" M	1/2" M	13 x 20	20 m/65 ft	24	TC13005K	
		VLX101615K	1/2" M	1/2" M	16 x 23	15 m/50 ft	24	TC16005K	
Water Acqua 90°C	10 Bar/140 PSI Blue Rubber/Gomma	VLX101320KR	1/2" M	1/2" M	13 x 21	20 m/65 ft	24	TC1301KR	
		VLX101615KR	1/2" M	1/2" M	16 x 25	15 m/50 ft	24	TC1601KR	
Water Acqua 150°C	250 Bar/3500 PSI 1SC Hydro blue 400 Bar/5600 PSI 2SC Hydro blue	VLX2H3820	3/8" F	3/8" M	3/8"	20 m/65 ft	27	TC38005H	
		VLX4H3820	3/8" F	3/8" M	3/8"	20 m/65 ft	27	TC38005H	•
		VLX4H5120	3/8" F	3/8" M	5/16"	20 m/65 ft	26	TC38005H	
		*VLX4H3820X	3/8" F	3/8" F	3/8"	20 m/65 ft	27	not available	

* Hose with stainless steel fittings / Tubo con raccordi in acciaio inox

VGX versatile large

STAINLESS STEEL AISI 304

ø 410 mm
drum/tamburo

optional
AXSG15R



P12A95



II 2G/D
optional



Schlauchaufroller für Waschvorgänge mit Wasser und Reinigungsmittel, sowie bei lebensmittelechtem Schlauch auch zum Transport von Trinkwasser.

Schwenkbare Arme für 3 versch. Positionen (s.Abb. A-B-C).

Serienmäßig: Verbindungsschlauch bei angegebenen Versionen, seitliche Schutzverkleidungen

Optional: Verbindungsschlauch, Schwenkkonsole.

Dimensions (mm) / Dimensioni (mm)

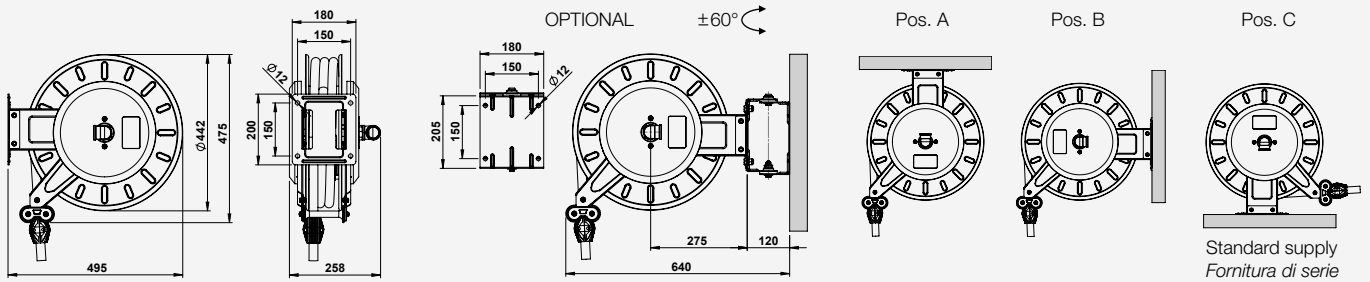

Spring side with guide hose arms in C position
Lato molla con bracci guida tubo in posizione C



Hose reels model VGX without hose / Avvolgitubo modello VGX senza tubo

Fluid Fluido	Max. pressure Pressione max.	Code Codice	Inlet Entrata	Outlet Uscita	Capacity Capacità	Weight (kg)	ATEX (optional)
Cold Water/Acqua fredda	20 Bar/280 PSI Composite Swivel Giunto composito	VGX205820ST	Ø19 mm	Ø 13 mm Ø 16 mm	(ext. Ø17) 20 m/65 ft (ext. Ø20) 15 m/50 ft	16	
Water/Acqua 100°C	20 Bar/280 PSI	VGX203408STMX	G 1" F	Ø19 mm	(3/4") 8 m/26 ft	16	•

Hose reels model VGX with hose / Avvolgitubo modello VGX completi di tubo

Fluid Fluido	Pressure - Hose Pressione - Tubo	Code Codice	Inlet Entrata	Outlet Uscita	Hose diam. Tubo diam.	Hose length Lungh. Tubo	Weight (kg) Peso (kg)	Inlet hose Tubo entrata
Cold water Acqua fredda	10 Bar/140 PSI PVC yellow/giallo	VGX101320T	Ø 19 mm	G 1/2" M	12,5 x 17	20 m/65 ft	20	Included
		VGX101615T	Ø 19 mm	G 1/2" M	15 x 20	15 m/50 ft	20	Included
Water Acqua 70°C	10 Bar/140 PSI (70°C) 20 Bar/280 PSI (25°C) Blue Thermoplastic	VGX101908KMX	G 1" F	G 3/4" F	19 x 27	8 m/26 ft	20	T1901KL

VGLX versatile large

STAINLESS STEEL AISI 304/316



ø 450 mm
drum/tamburo

4R 4-rollers hose guide
Guida tubo a 4 rulli

optional
ALXSG20R

P12A80/P12A95

II 2G/D
optional



4R - Standard 4-rollers support
on versions indicated in the table
4R - Guida tubo a 4 rulli di serie
per le versioni indicate in tabella



Spring side with guide hose
arms in C position
*Lato molla con bracci guida
tubo in posizione C*



Schlauchaufroller für Waschvorgänge mit Wasser und Reinigungsmittel oder zur Verteilung von Diesel-Kraftstoff, sowie bei lebensmittelechtem Schlauch auch zum Transport von Trinkwasser.

Auch in der Variante „TX“ in AISI 316 erhältlich.

Schwenkbare Arme für 3 versch. Positionen (s.Abb. A-B-C).

Serienmäßig: Verbindungsschlauch und Schlauchführung mit 4 Rollen bei angegebenen Versionen, seitliche Schutzverkleidungen

Optional: Verbindungsschlauch, Schwenkkonsole.

Dimensions (mm) / Dimensioni (mm)

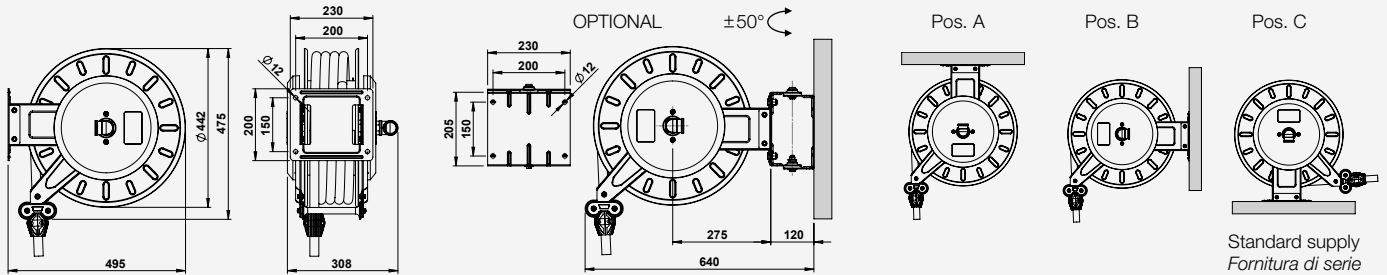

Hose reels model VGLX-VGLTX without hose / Avvolgitubo modello VGLX-VGLTX senza tubo

Fluid Fluido	Max. pressure Pressione max.	Code Codice	Inlet Entrata	Outlet Uscita	Capacity Capacità	Weight (kg) Peso (kg)	ATEX (optional)	"TX" AISI 316
Cold Water Acqua fredda	20 Bar/280 PSI Composite Swivel Giunto composito	*VGLX205825ST	Ø 19 mm	Ø 13 mm Ø 16 mm	(ext. Ø17) 25 m/80 ft (ext. Ø20) 20 m/65 ft	21,5		
Diesel fuel Gasolio Water Acqua 100°C	60 Bar/840 PSI	*VGLX601225STMX	G 1/2" M	G 1/2" M	(1/2") 25 m/80 ft (5/8") 20 m/65 ft	21,5	•	
	20 Bar/280 PSI	VGLX203415STMX	G 1" F	Ø 19 mm	(3/4") 15 m/50 ft	21,5	•	
Water Acqua 150°C	20 Bar/280 PSI	VGLX200110STMX	G 1" F	Ø 25 mm	(1") 10 m/32 ft	21,5	•	
	60 Bar/840 PSI	VGLX603415ST	G 1" M	G 3/4" M	(3/4") 15 m/50 ft	21,5	•	
	400 Bar/5600 PSI	*VGLX4H3825ST	G 3/8" F	G 3/8" M	25 m/80 ft	21,5	•	
Water Acqua 150°C	400 Bar/5600 PSI	△ VGLX4H1224ST	G 1/2" M	G 1/2" M	(1/2"-1SC) 24 m/78 ft (1/2"-2SC) 20 m/65 ft	21,5	•	
	60 Bar/840 PSI	VGLTX600115ST	G 1" M	G 3/4" M G 1" M	(3/4") 15 m/50 ft (1") 10 m/32 ft	22	•	•
Water Acqua 150°C	400 Bar/5600 PSI	△ VGLTX4H1225ST	G 1/2" M	G 3/8" M G 1/2" M	(3/8") 25 m/80 ft (1/2"-1SC) 24 m/78 ft (1/2"-2SC) 20 m/65 ft	21,5	•	•

* With 4-rollers hose guide / Con guida tubo a 4 rulli

△ Without lateral covers / Senza carter laterali

Hose reels model VGLX with hose / Avvolgitubo modello VGLX con tubo

Fluid Fluido	Pressure - Hose Pressione - Tubo	Code Codice	Inlet Entrata	Outlet Uscita	Hose diam. Tubo diam.	Hose length Lungh. Tubo	Weight (kg) Peso (kg)	Inlet hose Tubo entrata	ATEX (optional)
Diesel fuel Gasolio	10 Bar/140 PSI Rubber/Gomma R<10 ⁶ Ohm/m	VGLX101915GOMX	G 1" F	G 1" M	19 x 27	15 m/50 ft	28	T1901GL	•
		VGLX102510GOMX	G 1" F	G 1" M	25 x 35	10 m/32 ft	28	T2501GL	•
Cold water Acqua fredda	10 Bar/140 PSI PVC yellow/giallo	*VGLX101620T	Ø 19 mm	G 1/2" M	15 x 20	20 m/65 ft	27	Included	
		*VGLX101625T	Ø 19 mm	G 1/2" M	15 x 20	25 m/80 ft	28	Included	
		VGLX101915T	Ø 19 mm	G 3/4" M	19 x 25	15 m/50 ft	27	Included	
Water Acqua 70°C	10 Bar/140 PSI (70°C) 20 Bar/280 PSI (25°C) Blue Thermoplastic	*VGLX101325K	G 1/2" M	G 1/2" M	13 x 20	25 m/80 ft	28	TC13005K	
		*VGLX101620K	G 1/2" M	G 1/2" M	16 x 23	20 m/65 ft	28	T1601KL	
		VGLX101910KMX	G 1" F	G 3/4" F	19 x 27	10 m/32 ft	26	T1901KL	
		VGLX101915KMX	G 1" F	G 3/4" F	19 x 27	15 m/50 ft	28	T1901KL	
Water Acqua 90°C	10 Bar/140 PSI Blue Rubber/Gomma	VGLX102510KMX	G 1" F	G 1" F	25 x 34	10 m/32 ft	28	T2501KL	
		*VGLX101325KR	G 1/2" M	G 1/2" M	13 x 21	25 m/80 ft	28	TC1301KR	
Water Acqua 150°C	250 Bar/3500 PSI 1SC Hydro blue	*VGLX101620KR	G 1/2" M	G 1/2" M	16 x 25	20 m/65 ft	28	TC1601KR	
		*VGLX2H3825	G 3/8" F	G 3/8" M	3/8"	25 m/80 ft	31	TC3801H	•
Water Acqua 150°C	400 Bar/5600 PSI 2SC Hydro blue	*VGLX4H3825	G 3/8" F	G 3/8" M	3/8"	25 m/80 ft	31	TC3801H	•
		*□ VGLX4H3825X	G 3/8" F	G 3/8" F	3/8"	25 m/80 ft	31	Not available	•

* With 4-rollers hose guide / Con guida tubo a 4 rulli

□ Hose with stainless steel fittings / Tubo con raccordi in acciaio inox

VGMX

versatile maxi
STAINLESS STEEL AISI 304/316



ø 445 mm
drum/tamburo

4R 4-rollers hose guide
Guida tubo a 4 rulli

 II 2G/D
optional



Schlauchaufroller für Waschvorgänge mit Wasser und Reinigungsmittel oder zur Verteilung von Diesel-Kraftstoff, sowie bei lebensmittelechtem Schlauch auch zum Transport von Trinkwasser. Auch in der Variante „TX“ in AISI 316 erhältlich.

Schwenkbare Arme für 3 versch. Positionen (s.Abb. A-B-C).

Serienmäßig: Verbindungsschlauch bei den angegebenen Versionen, Schlauchführung mit 4 Rollen, seitliche Schutzverkleidungen.

Optional: Verbindungsschlauch.

Dimensions (mm) / Dimensioni (mm)

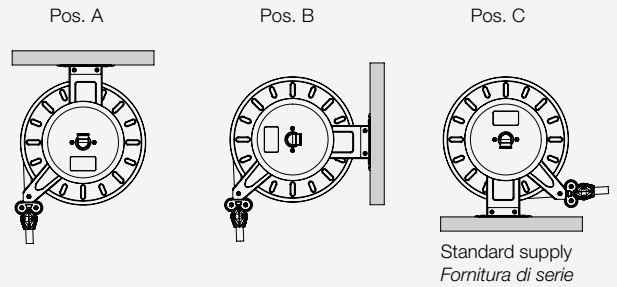
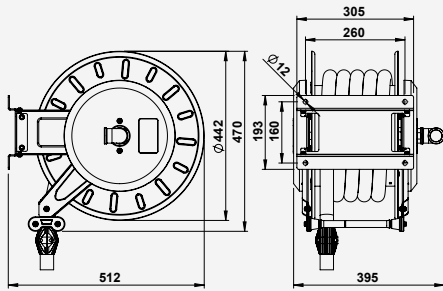

Spring side with guide hose arms in C position
Lato molla con bracci guida tubo in posizione C

Hose reels model VGMX - VGMTX without hose / Avvolgitubo modello VGMX - VGMTX senza tubo

Fluid Fluido	Max. pressure Pressione max.	Code Codice	Inlet Entrata	Outlet Uscita	Capacity Capacità	Weight (kg) Peso (kg)	ATEX (optional)	"TX" AISI 316
Diesel fuel/Gasolio Water/Acqua 100°C	20 Bar/280 PSI	VGMX203420STMX	G 1" F	Ø 19 mm	(3/4") 20 m/65 ft	22	•	
		VGMX200115STMX	G 1" F	Ø 25 mm	(1") 15 m/50 ft	22	•	
Water/Acqua 150°C	60 Bar/840 PSI	VGMX603420ST	G 1" M	G 3/4" M	(3/4") 20 m/65 ft	22	•	
Water/Acqua 150°C	60 Bar/840 PSI	*VGMTX600120ST	G 1" M	G 3/4" M G 1" M	(3/4") 20 m/65 ft (1") 15 m/50 ft	22	•	•

* 30 Bar/420 PSI for 1" hose / Per tubo 1"

Hose reels model VGMX with hose / Avvolgitubo modello VGMX completi di tubo

Fluid Fluido	Pressure - Hose Pressione - Tubo	Code Codice	Inlet Entrata	Outlet Uscita	Hose diam. Tubo diam.	Hose length Lungh. Tubo	Weight (kg) Peso (kg)	Inlet hose Tubo entrata	ATEX (optional)
Diesel fuel Gasolio	10 Bar/140 PSI Rubber/Gomma R <10 ⁶ Ohm/m	VGMX101920GOMX	G 1" F	G 1" M	19 x 27	20 m/65 ft	30	T1901GL	•
		VGMX102515GOMX	G 1" F	G 1" M	25 x 35	15 m/50 ft	32	T2501GL	•
Cold water Acqua fredda	10 Bar/140 PSI PVC yellow/giallo	VGMX101920T	Ø 19 mm	G 3/4" M	19 x 25	20 m/65 ft	29	Included	
Water Acqua 70°C	10 Bar/140 PSI (70°C) 20 Bar/280 PSI (25°C) Blue Thermoplastic	VGMX101920KMX	G 1" F	G 3/4" F	19 x 27	20 m/65 ft	30	T1901KL	
		VGMX102515KMX	G 1" F	G 1" F	25 x 34	15 m/50 ft	32	T2501KL	
Water Acqua 90°C	10 Bar/140 PSI Blue Rubber/Gomma	VGMX101920KR	G 1" F	G 3/4" F	19 x 28	20 m/65 ft	30	Not available	

BGX-BGDX heavy duty

STAINLESS STEEL AISI 304

ø 550 mm
drum/tamburo

connection hose included for versions with
hose. Not included for BGX4H3825X
*tubo di collegamento incluso per versioni
con tubo. Non incluso per BGX4H3825X*

optional
BGXSG30

P12A80/P12A95

 II 2G/D
optional



only for
solo per
BGX models



Spring side with guide-
hose arm in "B" position
*Lato molla con braccio
guidatubo in posizione B*



Schlauchaufroller für Waschvorgänge mit Wasser und Reinigungsmittel, sowie bei lebensmittelechtem Schlauch auch zum Transport von Trinkwasser.

Einfachhalterung mit äußerer Aufzugsfeder, kugelgelagerte Schlauchtrommel.

Schwenkbare Arme für 3 versch. Positionen (s.Abb. A-B-C).

Serienmäßig: Verbindungsschlauch bei Versionen mit Schlauch, Schlauchführung mit 4 Rollen, seitliche Schutzverkleidungen.

Optional: Schwenkkonsole.

Im Vertrieb der

Schäffner
ambt
www.schaeffner-tools.de

BGX

Dimensions (mm) / Dimensioni (mm)

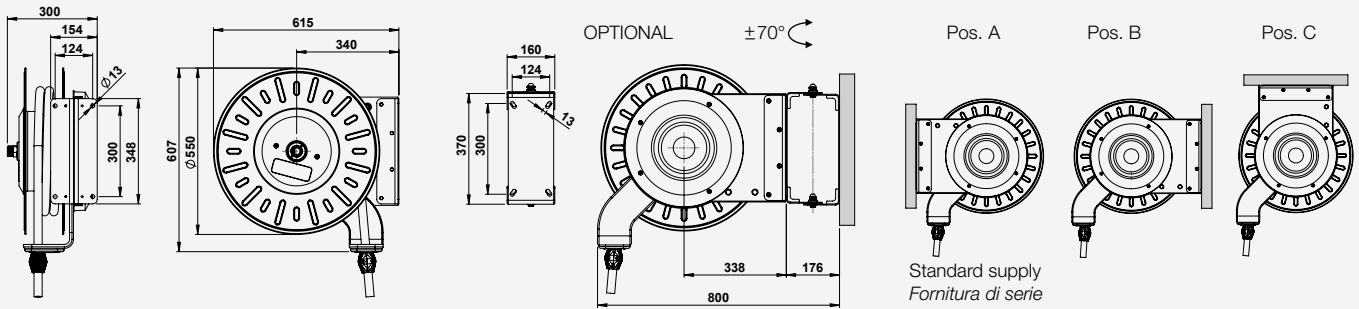

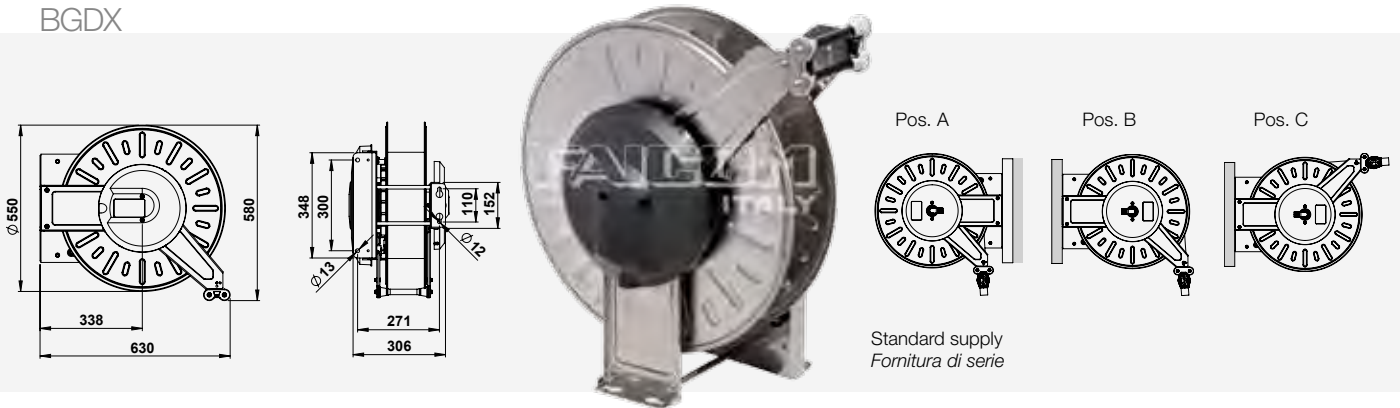

BGDx



Hose reels model BGX/BGDx without hose / Avvolgitubo modello BGX/BGDx senza tubo

Fluid Fluido	Max. pressure Pressione max.	Code Codice	Inlet Entrata	Outlet Uscita	Capacity Capacità	Weight (kg) Peso (kg)	ATEX (optional)
Water Acqua 150°C	60 Bar/840 PSI	BGX600125ST	1" M	3/4" F	(1") 15 m/50 ft (3/4") 20 m/65 ft	33	•
		BGX4H3830ST	3/8" F	3/8" M	30 m/100 ft	36	•
	400 Bar/5600 PSI	BGX4H1230ST	1/2" M	1/2" M	30 m/100 ft	36	•
		BGDx4H1240ST	1/2" M	3/8" M 1/2" M	40 m/130 ft	40	•

Hose reels model BGX with hose / Avvolgitubo modello BGX completi di tubo

Fluid Fluido	Pressure - Hose Pressione - Tubo	Code Codice	**Inlet (Bsp) **Entrata (Gas)	Outlet (Bsp) Uscita (Gas)	Hose diam. Tubo diam.	Hose length Lungh. Tubo	Weight (kg) Peso (kg)	ATEX (optional)	
Water Acqua 70°C	10 Bar/140 PSI (70°C) 20 Bar/280 PSI (25°C) Blue Thermoplastic 	BGX101325K	1/2" F	1/2" M	13 x 20	25 m/80 ft	41		
		BGX101330K	1/2" F	1/2" M	13 x 20	30 m/100 ft	42		
		BGX101625K	1/2" F	1/2" M	16 x 23	25 m/80 ft	42		
		BGX101920K	3/4" F	3/4" F	19 x 27	20 m/65 ft	42		
		BGX102515K	1" F	1" F	25 x 34	15 m/50 ft	44		
Water Acqua 90°C	10 Bar/140 PSI Blue Rubber/Gomma 	BGX101625KR	1/2" M	1/2" M	16 x 25	25 m/80 ft	42		
		BGX101920KR	3/4" F	3/4" F	19 x 28	20 m/65 ft	42		
Water Acqua 150°C	400 Bar/5600 PSI 2SC Hydro blue	BGX4H3825	3/8" F	3/8" M	3/8"	25 m/80 ft	45		
		BGX4H3830	3/8" F	3/8" M	3/8"	30 m/100 ft	48	•	
		*BGX4H3825X	3/8" F	3/8" F	3/8"	25 m/80 ft	45		
		300 Bar/4200 PSI 2SC Hydro blue	BGX3H1225	1/2" F	1/2" F	1/2"	25 m/80 ft	50	
			BGX3H1230	1/2" F	1/2" F	1/2"	30 m/100 ft	55	•

* Hose with stainless steel fittings / Tubo con raccordi in acciaio inox

** Fitting of the connection hose / Raccordo del tubo di collegamento

BGLX-BGLDX high capacity

STAINLESS STEEL AISI 304/316



ø 550 mm
drum/tamburo

connection hose included for versions with hose. Not included for BGLDX4H3850X
tubo di collegamento incluso per versioni con tubo. Non incluso per BGLDX4H3850X

optional
BGLXCS50



P12A80/P12A95



 II 2G/D
optional

Spring side with arms in "B" position
Lato molla con braccio in posizione B



Schlauchaufroller für Waschvorgänge mit Wasser und Reinigungsmittel oder zur Verteilung von Diesel-Kraftstoff, sowie bei lebensmittelechtem Schlauch auch zum Transport von Trinkwasser.

Auch in der Variante „TX“ in AISI 316 erhältlich.

Schwenkbare Arme für 3 versch. Positionen (s.Abb. A-B-C).

Serienmäßig: Verbindungsschlauch bei Versionen mit Schlauch, Schlauchführung mit 4 Rollen, seitliche Schutzverkleidungen

Optional: Wandbefestigung.

Im Vertrieb der

Schäffner
GmbH
www.schaeffner-tools.de

Dimensions (mm) / Dimensioni (mm)

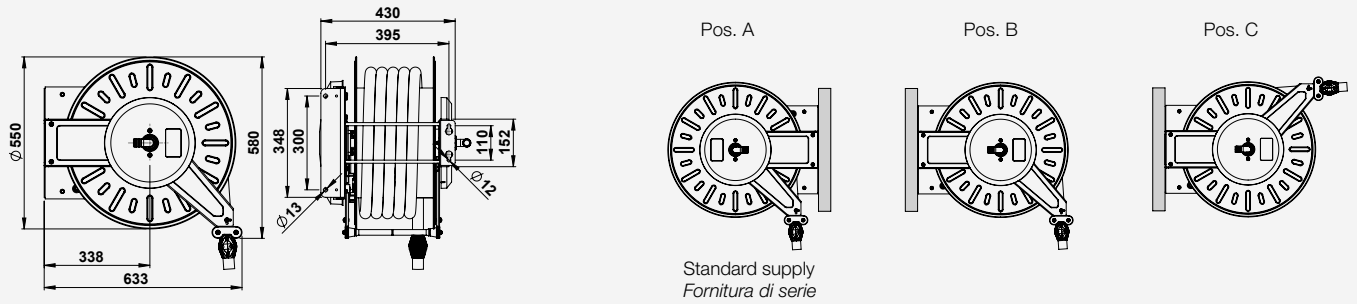

Hose reels model BGLX-BGLDX/TX without hose / Avvolgitubo modello BGLX-BGLDX/TX senza tubo

Fluid Fluido	Max. pressure Pressione max.	Code Codice	Inlet Entrata	Outlet Uscita	Capacity Capacità	Weight (kg) Peso (kg)	ATEX (optional)	"TX" AISI 316
Diesel fuel Gasolio Water Acqua 100°C	20 Bar/280 PSI	BGLX203430ST	G 1" F	Ø 19 mm	(3/4") 30 m/100 ft	39	•	
		BGLDX203440ST	G 1" F	Ø 19 mm	(3/4") 40 m/130 ft	46	•	
		BGLX200125ST	G 1" F	Ø 25 mm	(1") 25 m/80 ft	39	•	
		BGLDX200130ST	G 1" F	Ø 25 mm	(1") 30 m/100 ft	46	•	
Water Acqua 150°C	60 Bar/840 PSI	BGLX603430ST	G 1" M	G 3/4" M	(3/4") 30 m/100 ft	40	•	
		BGLDX603440ST	G 1" M	G 3/4" M	(3/4") 40 m/130 ft	47	•	
		BGLDX600125ST	G 1" M	G 1" M	(1") 25 m/80 ft	48	•	
	400 Bar/5600 PSI	BGLDX4H3850ST	G 3/8" F	G 3/8" M	(3/8") 50 m/160 ft	49	•	
		BGLDX4H1250ST	G 1/2" M	G 1/2" M	(1/2") 50 m/160 ft	49	•	
Water Acqua 150°C	60 Bar/840 PSI	BGLDTX600140ST	G 1" M	G 3/4" M G 1" M	(3/4") 40 m/130 ft (1") 25 m/80 ft	48	•	•
	400 Bar/5600 PSI	BGLDTX4H1250ST	G 1/2" M	G 3/8" M G 1/2" M	(3/8") 50 m/160 ft (1/2") 50 m/160 ft	49	•	•

Hose reels model BGLX - BGLDX with hose / Avvolgitubo modello BGLX - BGLDX completi di tubo

Fluid Fluido	Pressure - Hose Pressione - Tubo	Code Codice	**Inlet **Entrata	Outlet Uscita	Hose diam. Tubo diam.	Hose length Lungh. Tubo	Weight (kg) Peso (kg)	ATEX (optional)
Diesel fuel Gasolio	10 Bar / 140 PSI Rubber/Gomma R <10 ⁶ Ohm/m	BGLX102525GO	G 1" F	G 1" M	19 x 27	25 m/80 ft	50	•
		BGLDX102530GO	G 1" F	G 1" M	25 x 35	30 m/100 ft	66	•
Cold Water Acqua fredda	10 Bar/140 PSI Black-Blue PVC	BGLX101930HO	Ø 19 mm	G 3/4" F	19 x 26	30 m/100 ft	48	
		BGLDX101940HO	Ø 19 mm	G 3/4" F	19 x 26	40 m/130 ft	58	
Water Acqua 70°C	10 Bar/140 PSI (70°C) 20 Bar/280 PSI (25°C) Blue Thermoplastic	BGLDX101650K	G 1/2" F	G 1/2" M	16 x 23	50 m/160 ft	61	
		BGLX101930K	G 3/4" F	G 3/4" F	19 x 27	30 m/100 ft	52	
		BGLDX101940K	G 3/4" F	G 3/4" F	19 x 27	40 m/130 ft	63	
		BGLX102525K	G 1" F	G 1" F	25 x 34	25 m/80 ft	55	
		BGLDX102530K	G 1" F	G 1" F	25 x 34	30 m/100ft	65	
Water Acqua 150°C	250 Bar/3500 PSI 1SC Hydro blue	BGLDX2H3850	G 3/8" F	G 3/8" F	3/8"	50 m/160 ft	67	
	400 Bar/5600 PSI 2SC Hydro blue	BGLDX4H3850	G 3/8" F	G 3/8" F	3/8"	50 m/160 ft	67	•
		*BGLDX4H3850X	G 3/8" F	G 3/8" F	3/8"	50 m/160 ft	68	
	300 Bar/4200 PSI 2SC Hydro blue	BGLDX3H1250	G 1/2" F	G 1/2" F	1/2"	50 m/160 ft	79	•

* Hose with stainless steel fittings / Tubo con raccordi in acciaio inox

** Fitting of the connection hose / Raccordo del tubo di collegamento

Zubehör und Ersatzteile



Revolving Stands / Supporti Girevoli

ASG15R	mod. A - V - VG	Quick coupling, powder coated - Aggancio rapido, verniciato	2,5 Kg
ALSG20R	mod. AL - VL - VGL - OSV	Quick coupling, powder coated - Aggancio rapido, verniciato	2,9 Kg
VMSG30R	mod. OSVM	Quick coupling, powder coated - Aggancio rapido, verniciato	3,7 Kg
AXSG15R	mod. AX - VX - VGX	Quick coupling, stainless steel - Aggancio rapido, inox AISI 304	2,5 Kg
ALXSG20R	mod. ALX - VLX - VGLX	Quick coupling, stainless steel - Aggancio rapido, inox AISI 304	2,9 Kg



MCSG10	mod. MC	Powder coated - Verniciato	1,1 Kg
MCXSG10	mod. MCX	Stainless steel - Acciaio inox AISI 304	1,5 Kg



BGS30	mod. BG	Quick coupling, powder coated - Aggancio rapido, verniciato	6,5 Kg
BGXSG30	mod. BGX	Quick coupling, stainless steel - Aggancio rapido, inox AISI 304	6,5 Kg



Fixing brackets / Controstaffe di fissaggio

MCCC10	mod. MC	Fixing bracket - Controstaffa di fissaggio	1,8 Kg
ACS15	mod. A - V - VG	Fixing bracket - Controstaffa di fissaggio	1,3 Kg
ALCS20	mod. AL - VL - VGL - OSV	Fixing bracket - Controstaffa di fissaggio	1,6 Kg
BGLCS50	mod. BGL - BGLD	Fixing bracket - Controstaffa di fissaggio	4,5 Kg
BGLXCS50	mod. BGLX - BGLDX	Bracket fixing, stainless steel - Controstaffa di fissaggio, inox AISI 304	4,5 Kg



Fixing panels / Pannelli di fissaggio

PFA02	mod. MC - A - AL - V - VL - VGL	Fixing panel 2 hose reels - Pannello fissaggio 2 avvolgitubo	5,5 Kg
PFA03	mod. MC - A - AL - V - VL - VGL	Fixing panel 3 hose reels - Pannello fissaggio 3 avvolgitubo	8 Kg
PFA04	mod. MC - A - AL - V - VL - VGL	Fixing panel 4 hose reels - Pannello fissaggio 4 avvolgitubo	10,5 Kg



Anti-derailment brackets / Staffe antiscarrucolamento











VGSA20	mod. VG - V	Anti-derailment bracket - Staffa antiscarrucolamento	0,6 Kg
VGLSA25	mod. VGL - VL - OSV	Anti-derailment bracket - Staffa antiscarrucolamento	0,6 Kg



Covers / Carter

VCAR	mod. V - VL - VX - VLX	Lateral protective covers - Carter laterali di protezione	1 Kg
-------------	------------------------	---	------

Showers, Spray Guns, Nozzles / Doccette, Pistole

	DC38S	For water Per acqua	Shower with support - Doccetta con supporto 60°C max. - 10 l/min - 5 bar - F.3/8" bsp	0,3 Kg
	DC38PRS	For water Per acqua	Chrome-plated brass shower with support Doccetta in ottone cromato con supporto 70°C max. - 11 l/min - 7 bar - F.3/8" bsp	0,7 Kg
	P12ARNF	For water Per acqua	Plastic spray gun with quick coupling. Pencil or cone jet adjusting Pistola in plastica con innesto rapido. Getto a spillo o a cono regolabile 60°C max. - 10 l/min - 4 bar - F.1/2" bsp	0,4 Kg
	P12A80	For water Per acqua	Shockproof plastic spray gun with pencil or cone jet Pistola in plastica antiurto con getto a spillo o a cono 80°C max. - 50 l/min - 12 bar - F.1/2" bsp	0,5 Kg
	P12A95	For water Per acqua	Chrome-plated brass spray gun with pencil or cone jet adjusting Pistola in ottone cromato con getto a spillo o a cono regolabile 90°C max. - 100 l/min - 24 bar - F.1/2" bsp	1,1 Kg
	P38AV	For water, antifreeze, windshield liquid Per acqua, antigelo, lavavetri	Nickel-plated brass gun Pistola in ottone nichelato 30 l/min (4 bar) - 30 bar - F.3/8" bsp - ø 12 mm	0,3 Kg
	PGM80S	For Diesel Fuel Per gasolio	Manual nozzle with 1" swivel Pistola manuale con snodo 1" 80 l/min - 6 bar - F.1" bsp - ø 25 mm	0,6 Kg
	PGA60S	For Diesel Fuel Per gasolio	Automatic nozzle with 1" swivel Pistola automatica con snodo 1" 60 l/min - 8 bar - F.1" bsp - ø 20 mm	1,3 Kg
	PGA120S	For Diesel Fuel Per gasolio	Automatic nozzle with 1" swivel Pistola automatica con snodo 1" 120 l/min - 8 bar - F.1" bsp - ø 29 mm	1,3 Kg
	PPM90ADB	For Urea Per Urea	Manual plastic nozzle with ø 19 mm swivel Pistola manuale con snodo ø 19 mm 90 l/min - 6 bar - ø 19 mm swivel - ø 19 mm	0,3 Kg
	PAX70ADB	For Urea Per Urea	Stainless steel automatic nozzle with ø 19 mm swivel Pistola automatica in acciaio inox con snodo ø 19 mm 70 l/min - 8 bar - ø 19 mm swivel - ø 19 mm	2,6 Kg



0342
0127
0022A
0022B
0022C

0022C1
0022E
0022F
0022G

Hose stoppers/Tamponi di fine corsa

0342	for hose - per tubo	Ext. Ø 11 mm	0,07 kg
0127	for hose - per tubo	Ext. Ø 12 mm	0,06 kg
0022A	for hose - per tubo	Ext. Ø 14 mm (1/4")	0,07 kg
0022B	for hose - per tubo	Ext. Ø 17 mm (3/8")	0,07 kg
0022C	for hose - per tubo	Ext. Ø 20 mm (1/2")	0,06 kg
0022C1	for hose - per tubo	Ext. Ø 20 mm (1/2")	0,09 kg
0022E	for hose - per tubo	Ext. Ø 23 mm (5/8")	0,09 kg
0022F	for hose - per tubo	Ext. Ø 27 mm (3/4")	0,09 kg
0022G	for hose - per tubo	Ext. Ø 33 mm (1")	0,09 kg



0065A
0065D

0066A
0066A1

0066B
0066C

Swivel joints/Giunti girevoli

for all models - per tutti i modelli

Zinc-plated steel - Acciaio zincato:

0065A	60 bar	F.3/8" Bsp	PU	Air, water, oil - Aria, acqua, olio	0,21 kg
0065D	60 bar	M.1/2" Bsp	PU	Air, water, oil - Aria, acqua, olio	0,23 kg
0066A	400 bar	F.1/4" Bsp	NBR-PTFE	Grease - Grasso	0,27 kg
0066A1	400 bar	F.3/8" Bsp	NBR-PTFE	Grease - Grasso	0,27 kg
0066B	400 bar	F.3/8" Bsp	SIL-PTFE	Water 150°C - Acqua 150°C	0,27 kg
0066C	400bar	F.3/8" Bsp	VITON-PTFE	Paint - Vernice	0,27 kg

Stainless steel AISI 303 - Acciaio inox AISI 303:

0065VAX	60 bar	M.1/2" Bsp	VITON	Water 100°C - Acqua 100°C	0,23 kg
0065EX	60 bar	M.1/2" Bsp	EPDM	Antifreeze, windshield liquid Antigelo, liquido lavavetri	0,23 kg
0066BX	400 bar	F.3/8" Bsp	SIL-PTFE	Water 150°C - Acqua 150°C	0,27 kg
0238X	400 bar	M.1/2" Bsp	SIL-PTFE	Water 150°C - Acqua 150°C	0,27 kg
0238TX (AISI 316)	400 bar	M.1/2" Bsp	VITON-PTFE	Water 150°C - Acqua 150°C	0,27 kg

for mod: VG - VGL - BGL - BGLD - VGX - VGLX - BGL - BGLX

Brass - Ottone:

0636G	20 bar	F.1" Bsp	NBR	Diesel fuel - Gasolio	0,43 kg
0636GC	20 bar	F.1" Bsp	NBR	Air, Water 100°C - Aria, Acqua 100°C	0,43 kg

Zinc-plated steel - Acciaio zincato:

0586	60 bar	M.1" Bsp	PU	Oil, Water - Olio, Acqua	0,52 kg
-------------	--------	----------	----	--------------------------	---------

Composite - Composito:

0523A	20 bar	Ø 19	NBR	Urea, Water 50°C - Urea, Acqua 50°C	0,15 kg
0524A	20 bar	Ø 25	NBR	Water 50°C - Acqua 50°C	0,15 kg

Stainless steel AISI 303 - Acciaio inox AISI 303

0636GX	20 bar	F.1" Bsp	VITON	Water 100°C - Acqua 100°C	0,43 kg
0586X	60bar	M.1" Bsp	VITON-PTFE	Water 150°C - Acqua 150°C	0,52 kg
0586TX (AISI 316)	60bar	M.1" Bsp	VITON-PTFE	Water 150°C - Acqua 150°C	0,52 kg

for BG BGX models - per modelli BG BGX

Stainless steel AISI 303 - Acciaio inox AISI 303

BG0238CPL	400 bar	M.F.1/2" Bsp	SIL-PTFE	Water 150°C - Acqua 150°C	0,68 kg
BG0293P	60 bar	M.1" - F.3/4" Bsp	PU	Air, water, oil - Aria, acqua, olio	1,35 kg
BG0293S	60 bar	M.1" - F.3/4" Bsp	SIL-PTFE	Water 150°C - Acqua 150°C	1,35 kg

Swivel joints adapters/Adattatori per giunti girevoli

Zinc-plated steel - Acciaio zincato:

0187M38	400 bar	M.3/8" Bsp	Air, Water, Oil, Grease - Aria, Acqua, Olio, Grasso	0,11 kg
0187F38	400 bar	F.3/8" Bsp	Air, Water, Oil, Grease - Aria, Acqua, Olio, Grasso	0,12 kg
0187F12	400 bar	F.1/2" Bsp	Air, Water, Oil, Grease - Aria, Acqua, Olio, Grasso	0,13 kg

Stainless steel AISI 303 - Acciaio inox AISI 303:

0187M38X	400 bar	M.3/8" Bsp	Water 150°C - Acqua 150°C	0,11 kg
0187F38X	400 bar	F.3/8" Bsp	Water 150°C - Acqua 150°C	0,12 kg
0187F12X	400 bar	F.1/2" Bsp	Water 150°C - Acqua 150°C	0,13 kg

Connection Hoses/Tubi di collegamento

Code Codice	Fluid Fluido	Pressure Pressione	Hose Tubo	Diameter Diametro	Bsp thread Filett. Gas	Type Tipo	Length (m) Lungh. (m)	Hose reel Avvolgitubo	Weight (kg) Peso (kg)
0161	Air/Aria	20 bar	Polyurethane	8 x 12	3/8"	M + L	1	MNR - MDR	0,10
0305	Air/Aria	20 bar	Polyurethane	10 x 14	3/8"	M + L	1	MDR	0,10
TC08005PU	Air/Aria	20 bar	Polyurethane	8 x 12	3/8"	M + F	0,5	MC - A - AL - V - VL	0,17
TC10005PU	Air/Aria	20 bar	Polyurethane	10 x 14	3/8"	M + F	0,5	MC - A - AL - V - VL	0,20
TC13005PU	Air/Aria	20 bar	Polyurethane	13 x 18	1/2"	F + F	0,5	MC - A - AL - V - VL	0,35
TC10005SG	Air/Aria - Water/Acqua	18 bar	Thermoplastic	10x15	3/8"	M + F	0,5	V	0,20
TC13005SG	Air/Aria - Water/Acqua	18 bar	Thermoplastic	13x18	1/2"	F + F	0,5	V - VL	0,35
TC08005	Air/Aria - Water/Acqua	18 bar	Rubber	8 x 14	3/8"	M + F	0,5	MC - A - AL - V - VL	0,20
TC10005	Air/Aria - Water/Acqua	18 bar	Rubber	10 x 17	3/8"	M + F	0,5	MC - A - AL - V - VL	0,22
TC13005	Air/Aria - Water/Acqua	18 bar	Rubber	13 x 20	1/2"	F + F	0,5	MC - A - AL - V - VL	0,36
TC16005	Air/Aria - Water/Acqua	18 bar	Rubber	16 x 23	1/2"	F + F	0,5	MC - A - AL - V - VL	0,38
T1301L	Air/Aria - Water/Acqua	18 bar	Rubber	13 x 20	1/2"	F + L	1	VGL	0,32
T1601L	Air/Aria - Water/Acqua	18 bar	Rubber	16 x 23	1/2"	F + L	1	VGL	0,40
T1901L	Air/Aria - Water/Acqua	18 bar	Rubber	19 x 27	3/4"	M + L	1	VG - VGL - VGM	0,54
T2501L	Air/Aria - Water/Acqua	18 bar	Rubber	25 x 34	1"	M + L	1	VGL - VGM	0,70
TC13005MXE	Antifreeze/Antigelo Windshield fluid/Lavavetri	18 bar	Rubber	13 x 20	1/2"	F + F	0,5	MC - V - VL	0,36
T1901GL	Diesel fuel/Gasolio	10 bar	Rubber	19 x 27	1"	M + L	1	VG - VGL - VGM(X)	0,54
T2501GL	Diesel fuel/Gasolio	10 bar	Rubber	25 x 35	1"	M + L	1	VGL - VGM(X)	0,70
T3401A	Waste oil/olio esausto	Suction	PVC/PU Spiral	19 x 27	1" - 3/4"	M + F	1	VGL	0,70
T0101A	Waste oil/olio esausto	Suction	PVC/PU Spiral	25 x 35	1"	M + F	1	VGL	0,90
TC38005	Oil/Olio	60 bar	Rubber 1SC	3/8"	3/8"	M + F	0,5	MC - A - AL - V - VL	0,35
TC12005	Oil/Olio	60 bar	Rubber 1SC	1/2"	1/2"	F + F	0,5	MC - A - AL - V - VL	0,48
TC1201	Oil/Olio	60 bar	Rubber 1SC	1/2"	1/2"	F + F	1	VGL	0,65
TCN3401	Oil/Olio	60 bar	Rubber 1SC	3/4"	1" - 3/4"	F90 + F	1	VGL	1,10
TCN0101	Oil/Olio	60 bar	Rubber 1SC	1"	1"	F90 + F	1	VGL	1,60
TC14005	Grease/Grasso	400 bar	Rubber 2SN	1/4"	1/4"	M + F	0,5	MC - A - AL - V - VL	0,30
TC38005G	Grease/Grasso	400 bar	Rubber 2SC	3/8"	3/8"	M + F	0,5	AL - VL	0,45
TC13005K	Water/Acqua 70°C	10 bar	Thermoplastic Blue	13 x 21	1/2"	F + F	0,5	MCX - AX - ALX - VX - VLX	0,36
TC16005K	Water/Acqua 70°C	10 bar	Thermoplastic Blue	16 x 24	1/2"	F + F	0,5	MCX - AX - ALX - VX - VLX	0,38
T1601KL	Water/Acqua 70°C	10 bar	Thermoplastic Blue	16 x 24	1/2"	F + L	1	VGL(X)	0,40
T1901KL	Water/Acqua 70°C	10 bar	Thermoplastic Blue	19 x 27	1"	M + L	1	VG - VGL - VGM(X)	0,54
T2501KL	Water/Acqua 70°C	10 bar	Thermoplastic Blue	25 x 35	1"	M + L	1	VGL(X) - VGM(X)	0,70
TC1301KR	Water/Acqua 90°C	10 bar	Rubber Blue	13 x 21	1/2"	F + F	1	ALX - VLX - VGLX	0,46
TC1601KR	Water/Acqua 90°C	10 bar	Rubber Blue	16 x 25	1/2"	F + F	1	ALX - VLX - VGLX	0,50
TC38005H	Water/Acqua 150°C	400 bar	Rubber 2SC	3/8"	3/8"	M + F	0,5	MC(X) - A/AL(X) - V/VL(X)	0,43
TC3801H	Water/Acqua 150°C	400 bar	Rubber 2SC	3/8"	3/8"	M + F	1	VGL(X)	0,65



Wall hose support / Supporto murale per tubo

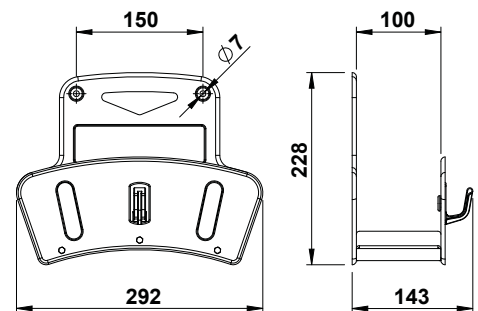

Im Vertrieb der
Schäffner GmbH
www.schaeffner-tools.de

Im Vertrieb der
Schäffner^{gmbh}
www.schaeffner-tools.de

Geschäftsbereich Tools & Service
Bahnhofstr. 119
73430 Aalen
Tel.: 07361/969659
post@schaeffner-tools.de